

 **VERTEX**
WATER PRODUCTS

***EVERCOOL WATER
DISPENSER***

OWNERS MANUAL

***MODELS: PWC-5280/PWC-5281/5280LX
HOT & COLD, COOK & COLD***

WARNING

- 1. For the point-of-use models PWC-5280, 5281 & 5280LX, the maximum water pressure is 100 psig. Measure the pressure of the inlet water. If it is 80 psig or more, a pressure regulator must be installed in the supply line. The pressure must be set at 60-65 psig*
- 2. Installing this water dispenser in an area where water may cause severe or costly damage is not recommended. If installation of this water dispenser/cooler is in an area where incidental water spillage may cause severe or costly damage, it is recommended that a water leak detector and shut-off valve accessory be installed in the supply line. (Vertex p/n LDM-1214)*
- 3. Do not install the dispenser where it can be bumped by vacuum cleaners or waxing machines, This can cause breaks in the water line, connection fittings, or compressor tubing.*
- 4. Do not locate cooler in direct sunlight or next to a heat source. Always maintain 4" of clearance around cooler for air circulation.*
- 5. Do not install in area where possibility of freezing may occur.*
- 6. Never transport or store cooler laying down.*

TABLE OF CONTENTS

1. Receiving/inspection
2. Assembly
3. Installation
4. Electrical
5. Installation
6. Start-up
7. Maintenance
8. Specifications
9. Warranty

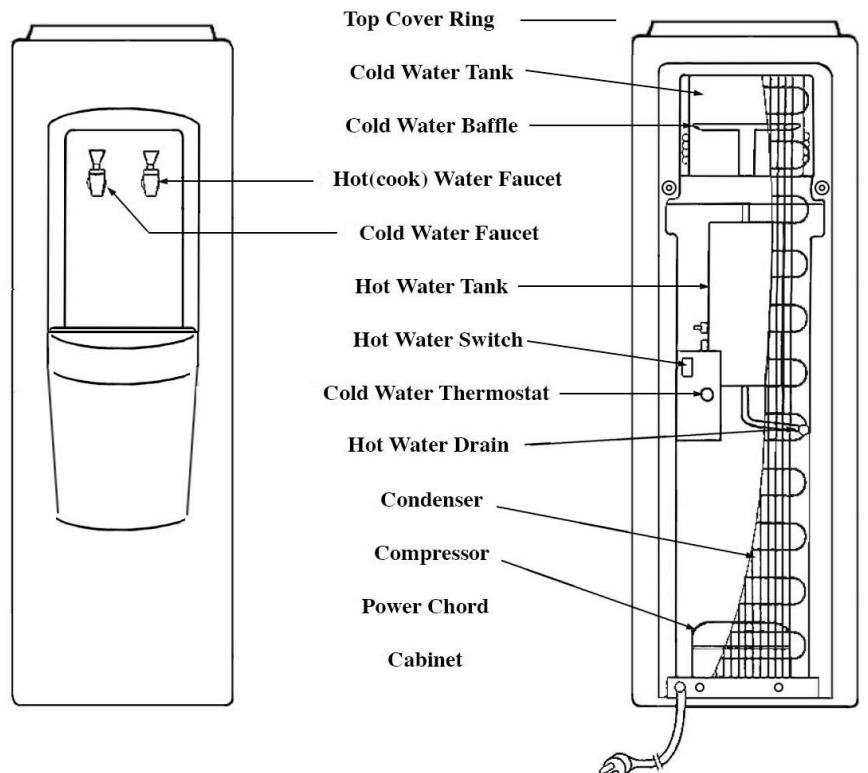
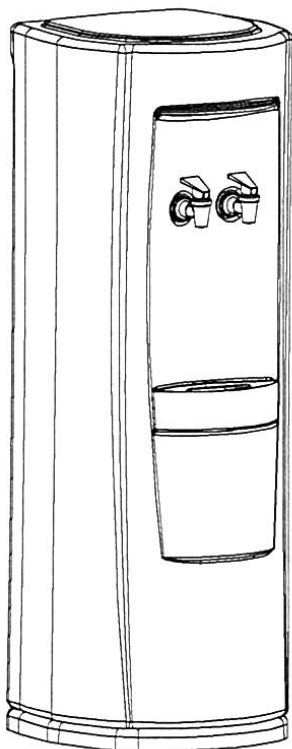

1. Figure 1

The Evercool water dispenser is shipped completely assembled and ready to operate. Remove the top of the shipping box and slide the VERTEX water dispenser out. Save the box and packing materials.

NOTE: A second box may be included if a filter option has been ordered.

Inspect the dispenser for shipping damage. Look at the exterior panels to see if they have been dented or broken. Check the dispensing spigots in the front for possible breakage. Check the bottom of the cabinet to see if the compressor, as received, has not been damaged or broken loose from its mounting.

2.0 Assembly

The standard PWC-5280/5281 requires a supply of clean filtered water. A 1/4-inch LDPE plastic tube on the back of the unit is for attaching to the water supply. The installer will need to provide appropriate size connection and tubing for connecting to feed water source.

3.0 Description

The assembled dispenser is shown in figure 1.

A schematic of the construction is shown in Figure 2.

A description of the Float Assembly which controls the supply water level is shown in Figure 3.

This consists of a primary float valve which controls the water level in the tank. It also contains a secondary float valve which blocks incoming water to the unit if the primary valve fails.

Note: If Secondary float is engaged for shut-off it must be reset for water to flow again: To reset, depress the red reset button shown in Figure 3.

Figure 2

Description of Float Kit

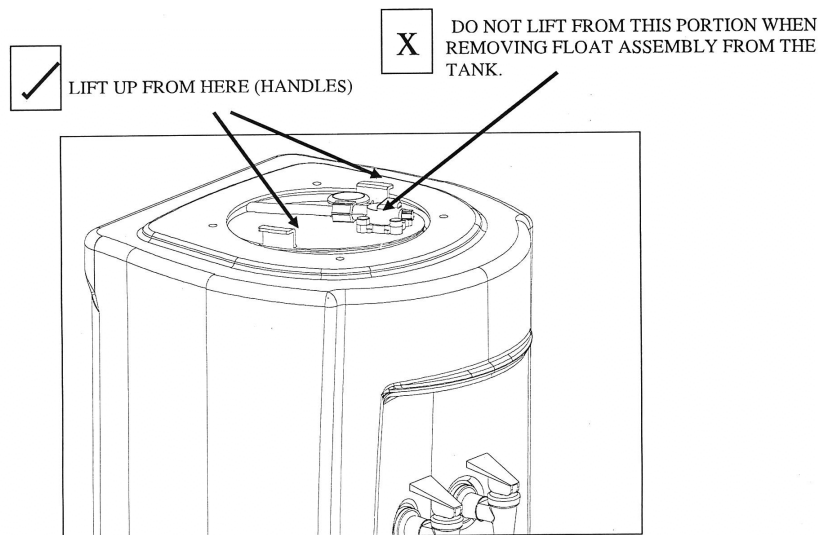
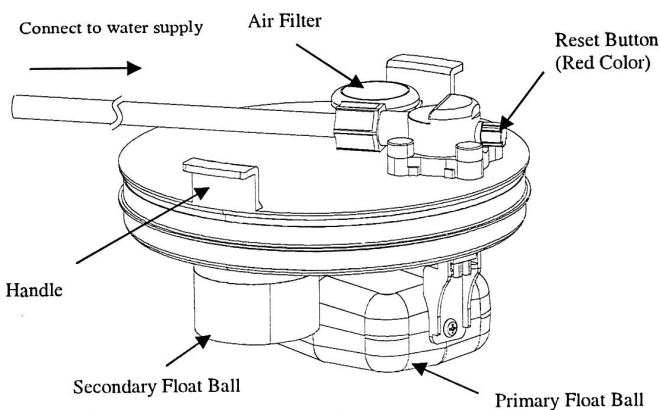

4.0 Electrical

Figure 3

The schematic of the electrical circuit, showing connection to the compressor and the hot tank is shown of Figure 4.

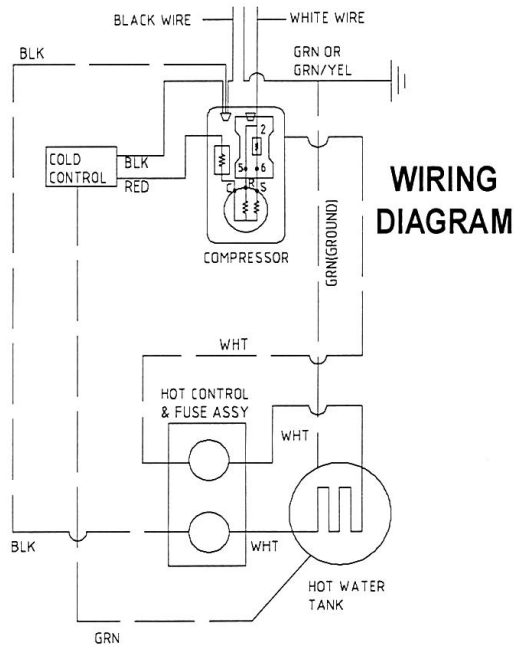

Figure 4

5.0 Installation

Locate the water dispenser in a well ventilated space where the temperature is always above freezing.

Do Not locate cooler in direct sunlight or next to a heat source.

Insure proper ventilation by placing the cooler a minimum of 4-inches from a wall on the rear and sides of the cooler. Make sure the cooler/dispenser is on a level surface.

6.0 Startup

Clean the cooling tank and baffle.

Access by removing top cover ring and float assembly (see figure 3).

Use a solution of 2 tsp of 5.25% chlorine bleach in one gallon of water as the cleaning solution.

Pour into main tank; dispense a little water from each spigot then let sit for 5-10 minutes.

After 5-10 minutes drain water from hot drain on rear, then flush with clean water.

Before plugging in the power cord to an electrical outlet, make sure there is water in the tanks:

For Cook and Cold models (room temp and cold) hold the room temperature water faucet down to until water begins to dispense.

For HOT and Cold models, depress the safety lock and hold the HOT faucet down to assure down until water begins to dispense to ensure Hot water tank is full. (See figure below)

- (1)
Tilt handle up,
squeeze ends
together
- (2)
Continue
holding while
pushing down
- (3)
Keep ends
squeezed
together while
dispensing water

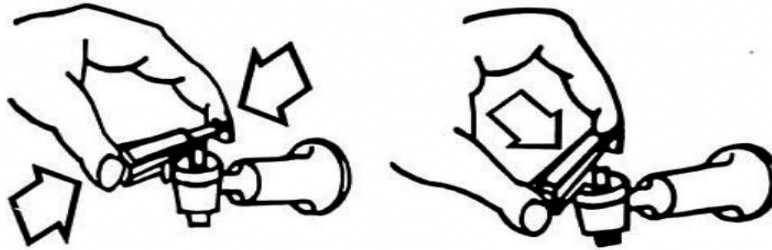

Once tanks are full with water plug into power supply and turn on Hot Power switch (Hot and Cold models)

Hot Power switch is located on the back of the cooler condenser at top left side.

- Turn the switch to 'ON' to enable heating function.
- Turn the switch to 'OFF' if hot water is not required.

7.0 Maintenance

Temperature control (cold control) thermostat is located at the rear of the cooler.

The thermostat is set to deliver water at approximately 7C (45 F). For colder water adjust the screw on the thermostat clockwise.

Hot thermostat is set at approximately 85C (185 F) and is not adjustable.

Condenser: The condenser is on the back of the cooler and consists of a grid of tubes to radiate heat. This must be kept clear of lint and dust. It should be regularly cleaned by brushing.

Drip Tray. The drip tray should be emptied and cleaned regularly. To remove, pull tray straight outward from the cabinet.

8.0 Specifications

Model:	PWC-5280 (Hot & Cold)	PWC-5281 (Cook & Cold)
Voltage	115 volts +/- 10 %, 1-ph, 60 HZ	
Dimension	12.5" W X 13" D X 38" H	
Weight (empty)	33 lbs.	
Hot/Room tank capacity	.32 gal	
Cold tank capacity	1 gal	
Power consumption	Hot water: 500W	
	Cold Water: 100W	Cold Water: 100W
Refrigerant	HFC 134A	
Electrical power Cord	6 Ft., 3-prong grounded	

9.0 Troubleshooting

Cooler won't operate	Check power plug, or power outlet
Water not dispensing	Check to ensure float assembly is not tripped Verify feed water valve is open Ensure filters (if connected) are not clogged
Water is not cold	Verify the unit is plugged in Verify usage is not exceeding GPH cooling capacity Check cooler is not in direct sunlight or too close to heat source Check thermostat setting, ¼ turn clockwise for colder water
Water is not hot	Check hot power switch is on. Switch be illuminated when ON

10.0 Warranty

Vertex Water Products ("Manufacturer") sell its products through independent retailer dealers ("Dealer") who resell to the end-user customer. In this limited warranty, "Vertex" refers to Vertex Water Products and not to the Dealer.

WHO IS COVERED BY THIS WARRANTY

This limited warranty covers only the first purchaser of the Vertex EverCool™ water cooler from a Dealer for use by that purchaser, and is not transferrable. "Consumer Use" means personal residential household use by a consumer or consumers. "Commercial Use" means all other uses, including (but not limited to) use for commercial, income producing purposes and/or when purchased by a business and/or when purchased for use in an office, business, or industrial setting. "Purchaser" means the end-user customer, and not a Vertex re-seller Dealer.

PERIOD OF COVERAGE OF THIS WARRANTY

Manufacturer warrants the complete water cooler ("the unit") against defects in material and workmanship, subject to the exclusions described below, for a period of ONE YEAR, beginning on the later of either (a) the date of purchase or (b) the date of manufacture as identified by the Vertex unit's serial number. Manufacturer additionally warrants the compressor for a period of THREE YEARS from the above date. The purchaser must provide the original sales receipt as proof of the date of purchase. If the purchaser is unable to produce the original sales receipt, the Warranty Period commencement date will be determined by Manufacturer, in its sole and absolute discretion, based upon the unit's serial number. This warranty does not apply if the original serial number affixed by Manufacturer is removed, defaced, altered, obscured, tampered with, or obliterated. If Manufacturer provides a replacement part or parts, or repairs a part or parts, under this limited warranty, then the replacement part(s) or repaired part(s) will be covered under this limited warranty for the time remaining under the original Warranty Period applicable to the part(s) repaired or replaced.

The duration of **ALL OTHER WARRANTIES, INCLUDING ANY AND ALL IMPLIED WARRANTIES, INCLUDING BUT NOT LIMITED TO MERCHANTABILITY AND FITNESS FOR A PARTICULAR PURPOSE, ARE RESTRICTED TO THE TWO-YEAR LIMITED WARRANTY PERIOD.** Some states do not allow limitations on how long an implied warranty lasts, so the above limitation may not apply to purchaser.

WHAT IS COVERED BY THIS WARRANTY

This limited warranty covers defects in materials or workmanship, subject to the exclusions below and for the time period stated above. Manufacturer promises to repair or to replace, at Manufacturer's sole and absolute discretion, any part of this water cooler that proves to be inoperative due to a defect in material or workmanship under normal use.

WHAT IS NOT COVERED BY THIS WARRANTY

This limited warranty does not extend to and expressly excludes:

- conditions, losses, malfunctions, or damages **not** resulting from defects in material or workmanship;
- conditions, malfunctions, losses, or damages or the inability to operate the Vertex unit resulting from conditions beyond Manufacturer's control, including but not limited to failure of the unit or any of its parts due to damage caused by: improper installation; accident; fire; flood; windstorm; acts of God; rodent and/or insect infestation; vandalism; modification; alteration; combination with any other device or machine; abuse and/or misuse of the unit; negligence by purchaser or third parties; any part of the water system that has become fouled due to liming, dirt, unsatisfactory/unsanitary water conditions, corrosion, or faulty plumbing; failure to install, maintain, assemble, mount or place the Vertex unit in accordance with Manufacturer's instructions and/or local, state, or national plumbing and electrical codes; wear and tear expected to occur in the normal course of use, including but not limited to cosmetic rust, scratches, dents or comparable and reasonably expected losses or damages; exposure to extreme variations in ambient environmental conditions (including but not limited to changes in heat, humidity, moisture, or exposure to sunlight).
- labor for installation or deinstallation of the unit or any of its parts; shipping of the unit or any of its parts to Manufacturer for repair/replacement.

In addition to the above exclusions, this limited warranty does not apply if any of the following conditions of operation are not met: **System Pressure 35 - 100 psi, Temperature 40 - 100 degrees F, PH range 4 - 10, Max TDS 1500 PPM Max., Turbidity <1.0NTU, Hardness <20gpg, R version: <3.5 gpg, F version, Iron <0.1 mg/l, Manganese <0.1 mg/l, Hydrogen Sulfid e <0.00 mg/l.**

NO OTHER EXPRESS OR IMPLIED WARRANTY APPLIES

This limited warranty is the sole and exclusive warranty provided to the purchaser identified above. No other express warranty, written or verbal, applies. No agent, employee, deal or other person or entity is authorized to alter this limited warranty or make any other warranty on behalf of Manufacturer. The terms of this limited warranty shall not be modified by the Manufacturer, the purchaser/end user, or their respective successors or assigns.

WHAT WE WILL DO TO CORRECT PROBLEMS/ HOW TO GET WARRANTY PARTS

If the Vertex unit does not operate in accordance with the documentation provided to purchaser, or purchaser have questions concerning purchasers' Vertex unit, please contact the Dealer from whom the unit was purchased. If the original Dealer is not available or the purchaser does not know who the Dealer is, please call or email the Manufacturer, Vertex, using the contact information provided below. We will try to find a Dealer in purchaser geographical area to assist purchaser. If a Dealer cannot be conveniently located, the Manufacturer, in its sole and absolute discretion, may offer two (2) options. First, we will attempt to troubleshoot the issue with purchaser over the phone. If the purchaser is comfortable making a repair/ replacing a part, once we understand the problem and its solution, we will send the replacement part(s) for the cooler. **This warranty is for the replacement of part(s) ONLY; it does not cover the cost of labor for either the Dealer or the end user/purchaser.** The second option is that the end user/purchaser may, after notifying Manufacturer and receiving written authorization/ approval from Manufacturer to do so, send the unit back to Manufacturer and we will repair it. **The end user purchaser must pay the freight/ shipping costs to return the unit to Manufacturer.** Manufacturer will pay the freight/shipping to return the unit to the end user/purchaser following repair.

If the end user/purchaser contacts the Dealer and the Dealer repairs the unit pursuant to this limited warranty, Manufacturer will provide parts to the Dealer at no charge; labor is not included in this limited warranty. The Dealer may, in his or her sole and absolute discretion, decide to repair the unit on-site or take the unit to a shop to repair.

This limited warranty covers replacement or repair of parts only. Manufacturer will not replace the entire unit if a part can be replaced or repaired to restore the unit to full operational function. On the rare occasion that a unit cannot be restored to full operation by a part or parts, Manufacturer will replace the unit after the end user/purchaser has shipped the unit to Manufacturer and Manufacturer has determined, in its sole and absolute discretion, that the unit cannot be repaired and must be replaced. **The end user/purchaser must pay the freight/shipping costs to return the unit to Manufacturer.** Manufacturer will pay the freight/shipping to return the unit to the end user/purchaser following repair or will ship a new unit if repair is not possible.

LIMITATION OF LIABILITY AND DISCLAIMER OF WARRANTIES

TO THE EXTENT PERMITTED BY LAW, IN NO EVENT SHALL MANUFACTURER BE LIABLE TO PURCHASER OR ANY THRID PARTIES FOR ANY INCIDENTAL, SPECIAL, INDIRECT, OR CONSEQUENTIAL DAMAGES, INCLUDING ANY ECONOMIC LOSS, WHETHER RESULTING FROM NON-PERFORMANCE, USE, MISUSE, OR INABILITY TO USE THE VERTEX UNIT. MANUFACTURER SHALL NOT BE LIABLE FOR DAMAGES CAUSED BY DELAY IN PERFORMANCE AND IN NO EVENT, REGARDLESS OF THE FORM OF THE CLAIM OR CAUSE OF ACTION (WHETHER BASED IN CONTRACT, WARRANTY, TORT, INFRINGEMENT, NEGLIGENCE, STRICT LIABILITY, OTHER TORT OR ANY OTHER LEGAL THEORY) SHALL MANUFACTURER'S ENTIRE LIABILITY EXCEED THE PRICE PAID BY THE ORIGINAL PURCHASER FOR THE VERTEX UNIT. THE TERM "CONSEQUENTIAL DAMAGES" SHALL INCLUDE, BUT NOT BE LIMITED TO, LOSS OF ANTICIPATED PROFITS, BUSINESS INTERRUPTION, LOSS OF USE OR REVENUE, COST OF CAPITAL, OR LOSS OR DAMAGE TO PROPERTY OR EQUIPMENT.

Contact information:

Vertex Water Products 5138 Brooks Street Montclair, California 91763
800-627-2146 www.vertexwater.com email: inquiries@vertexwater.com